

CONFIRMATION COPY FOLLOWS

RENO EVENING GAZETTE

PROOF OF PUBLICATION

STATE OF NEVADA }
COUNTY OF WASHOE } ss.

DOROTHY YOCOM

being first duly sworn, deposes and says: That she is the legal clerk of THE RENO EVENING GAZETTE, a daily newspaper published at Reno, in Washoe County, in the State of Nevada.

That the notice..... COUNTY ORDINANCE

.....
of which a copy is hereto attached, was first published in said newspaper in its issue dated the ..11.. day of June, 19 71.. and June 18, the full period of ..2... days, the last publication thereof being in the issue dated the....18.. day of June, 19 71..

Signed *Dorothy Yocom*.....

Subscribed and sworn to before me this ..18.. day of June, 19 71..

Richard J. Taylor
Notary Public.

RICHARD J. TAYLOR
Notary Public — State of Nevada
Washoe County
My Commission Expires Jan. 22, 1975

NOTICE OF COUNTY ORDINANCE
Notice is hereby given that Bill No. 263 Ordinance No. 136 entitled "An Ordinance to make it unlawful to discharge firearms on or across county roads, within 500 feet of a dwelling in the unincorporated area of the County and within a defined congested area in the unincorporated area of the County; requires reasonable posting by County of congested area in which discharge of firearms prohibited; prescribes penalties for violation thereof and other matters properly relating thereto." was adopted on June 7, 1971 by Commissioners Pagni, Coppa, McKisick, Rusk and Nelson all voting aye. Typewritten copies of the Ordinance are available for inspection by all interested persons at the office of the County Clerk.
H. K. BROWN, County Clerk
334900—Notice June 11 and 18

71-662

SUMMARY: Amends Washoe County Ordinance No. 136, Section 3 and Section 7 by designating an additional congested area and providing for deletion of designated congested areas upon annexation.

BILL NO. 263

ORDINANCE NO. 136

AN ORDINANCE TO MAKE IT UNLAWFUL TO DISCHARGE FIREARMS ON OR ACROSS COUNTY ROADS, WITHIN 500 FEET OF A DWELLING IN THE UNINCORPORATED AREA OF THE COUNTY AND WITHIN A DEFINED CONGESTED AREA IN THE UNINCORPORATED AREA OF THE COUNTY; REQUIRES REASONABLE POSTING BY COUNTY OF CONGESTED AREA IN WHICH DISCHARGE OF FIREARMS PROHIBITED; PRESCRIBES PENALTIES FOR VIOLATION THEREOF AND OTHER MATTERS PROPERLY RELATING THERETO.

THE BOARD OF COUNTY COMMISSIONERS OF WASHOE COUNTY DO ORDAIN:

That Sections 3 and 7 of Ordinance No. 136 are hereby amended to provide as follows:

SECTION 3. Determination of Congested Areas.

The following described areas within the unincorporated areas of Washoe County are hereby determined to be congested areas within the terms of this Ordinance:

- A. That area designated as Section 3-A on the map of Washoe County, Nevada attached hereto and incorporated herein, more specifically described as:

All that area within the following described boundary within the unincorporated area of Washoe County: Start at the intersection of the City of Reno boundary and Steamboat Ditch in the vicinity of Horseman's Park; thence along Steamboat Ditch to Lone Tree Lane; thence easterly along Lone Tree Lane, Lakeside Drive and Holcomb Lane to the intersection of Holcomb Lane and Thomas Creek Road to its intersection with Foothill Road; thence easterly and northeasterly along Foothill Road to its intersection with U. S. 395 South; thence northerly along U. S. 395 South to Longley Lane; thence northeasterly along Longley Lane and Boynton Lane to Pembroke Drive; thence easterly on Pembroke Drive to the Steamboat Creek; thence northeasterly along Steamboat Creek to the Truckee River; thence westerly along the Truckee River to the east boundary of the City of Reno in the vicinity of Kietzke Lane; thence southeasterly, southerly and westerly along the City of Reno boundary line to the point of beginning.

- B. That area designated as Section 3-B on the map of Washoe County, Nevada attached hereto and incorporated herein, more specifically described as:

All that area within the following described boundary within the unincorporated area of Washoe County: Start at the intersection of the Nevada-California State Line and the Truckee River; thence northeasterly and northerly and downstream along the Truckee River to the point of diversion of the Sierra Pacific Power Company Canal; thence

1.

(71-633) 71-662

northerly and downstream along the Canal to the South Verdi Road to Bridge Street; thence northwesterly along Bridge Street to Second Street; thence easterly along Second Street to the old U. S. Highway 40; thence easterly along the old U. S. Highway 40 to the Truckee River; thence northwesterly and upstream along the Truckee River to the mouth of the Verdi Substation discharge channel, further described as being the end of the Sierra Pacific Power Company Canal; thence westerly and upstream along the discharge channel, the penstock, flume and channel of the Canal to Bridge Street; thence northwesterly along Bridge Street to the Truckee River; thence southwesterly and upstream along the Truckee River to the mouth of Dog Creek located approximately one-half mile northwesterly of Verdi; thence northwesterly and westerly along Dog Creek to its intersection with the Nevada-California State Line; thence southerly along the Nevada-California State Line to the point of beginning.

- C. That area designated as Section 3-C on the map of Washoe County, Nevada attached hereto and incorporated herein, more specifically described as:

Beginning at the intersection of the Mt. Rose Highway, Nevada State Highway 27, and Callahan Road; thence southerly along Callahan Road to its intersection with Galena Creek; thence easterly and downstream along Galena Creek to the Sierra Pacific Power Company Washoe to Carson City 'H' frame power transmission line; thence southerly along the transmission line to the old Callahan Road; thence westerly and northerly along the old Callahan Road to a primary private road running westerly in the vicinity of the Galena Volunteer Fire Department and the former Galena Creek School site; thence westerly and southerly along the primary private road to its intersection near Brown's Creek with a Forest Service road, which extends from Washoe City to the old Boy Scout Camp; thence northerly and northwesterly along the Forest Service road to its intersection with Galena Creek; thence westerly and upstream along Galena Creek to its intersection with the Mt. Rose Highway; thence northerly and northeasterly along the Mt. Rose Highway to its intersection with Callahan Road, the place of beginning. (Amended by Bill Nos. 133 - 11/65; 165 - 10/66; 166 - 10/66 and 168 - 11/66.

- D. That area designated as Section 3-D on the map of Washoe County, Nevada attached hereto and incorporated herein, more specifically described as:

Beginning at the intersection of old U. S. Highway 395 North, Main Street in Black Springs and a major natural drainway; thence southwesterly along and up the major natural drainway, crossing the Western Pacific Railroad main line, 5100 feet to the intersection of an existing road or trail; thence northerly and westerly along the road or trail to the vicinity of the Horizon Hills water tank; thence northerly along an existing road or trail, crossing the Western Pacific Railroad main line and crossing the Western Pacific Railroad spur line to Stead, to old U. S. Highway 395 North in the vicinity of the entranceway to the Foothill Trailer Court; thence southeasterly along old U. S. Highway 395 North to the place of beginning. (Added by Bill No. 197 - 11/67).

(71-633)

71-662

E. That area designated as Section 3-E on the map of Washoe County, Nevada attached hereto and incorporated herein, more specifically described as:

All that certain area within the following described boundary within the unincorporated area of Washoe County: Commencing at the intersection of the north line of Wedekind Road with the east line of Sullivan Lane, the TRUE POINT OF BEGINNING; thence easterly and northeasterly along the said north line of Wedekind Road to the west line of State Route 33 (Pyramid Lake Highway); thence northerly along the said west line of State Route 33 (Pyramid Lake Highway) to an intersection with the Valley Road-to-Tracy 120 KV "H" frame power line; thence westerly along the said "H" frame power line to an intersection with the east line of Sullivan Lane; thence southerly along the said east line to the true point of beginning.

SECTION 7. Repeal.

- A. Ordinance No. 28 of Washoe County and Ordinance No. 29 of Washoe County are hereby repealed. All other ordinances or parts of ordinances, in conflict or inconsistent with this Ordinance are hereby repealed but only to the extent of such conflict or inconsistency.
- B. Any part or parts of the Congested Areas described in Section 3 which are annexed to and subsequently become a part of an incorporated city shall cease to exist as a Congested Area as provided by this Ordinance.

SECTION 9. This Ordinance shall be in full force and effect from and after its passage, approval and publication as prescribed by NRS 244.100.

Proposed on the 25th day of MAY, 1971.
Proposed by Commissioner COPPA.
Passed on the 7th day of JUNE, 1971.

Vote:

Ayes: Commissioners:	Pagni, Coppa, McKissick, Rusk and Nelson
Nays: Commissioners:	None
Absent: Commissioners:	None

ATTEST:



J. H. Brown
County Clerk

Roy Pagni
Chairman of the Board

This Ordinance shall be in force and effect from and after the 18th day of June, 1971.

(71-633)

71-662

(71-633) 71-662

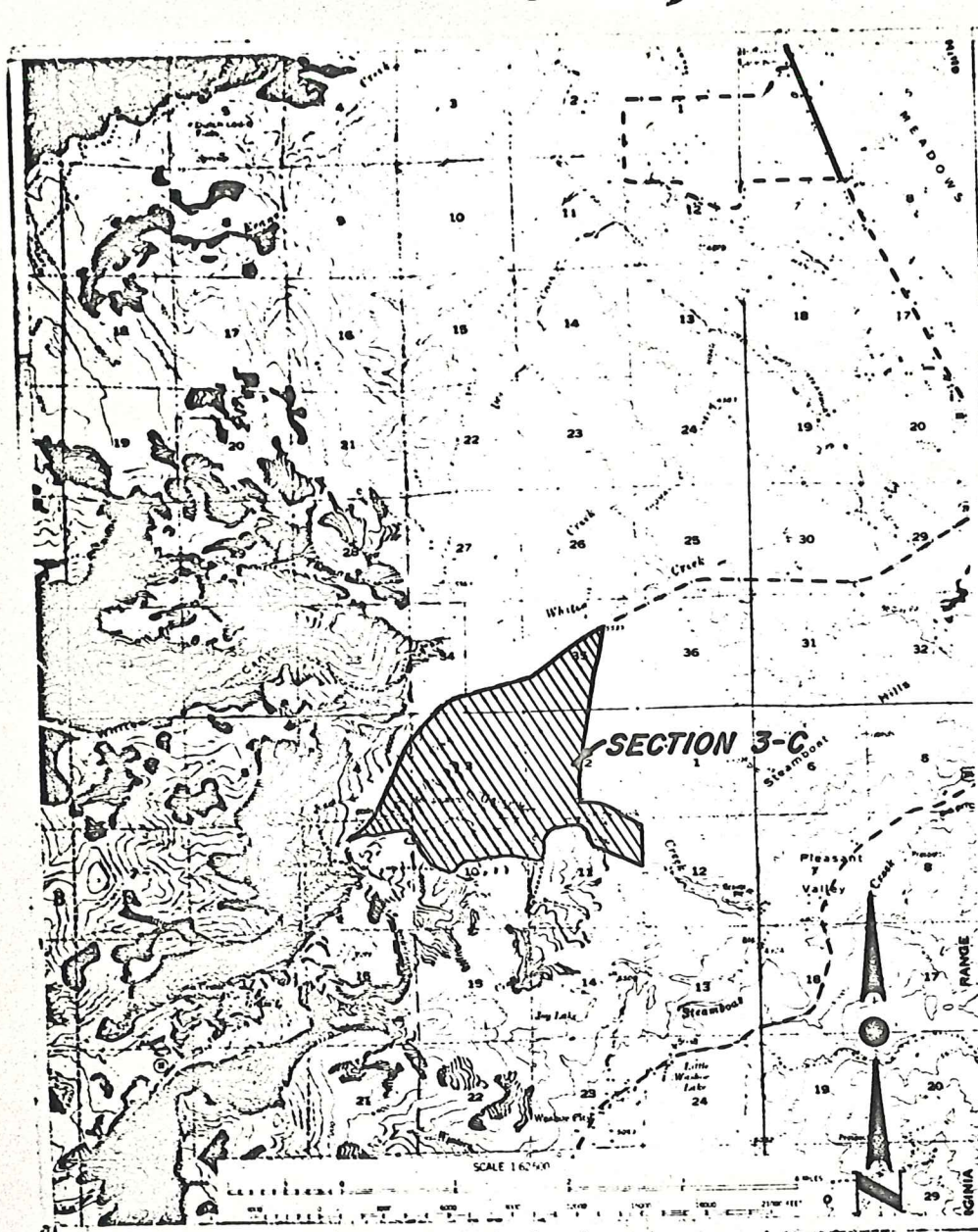

MAP TO ACCOMPANY ORDINANCE 136

Sheet 2 of 3

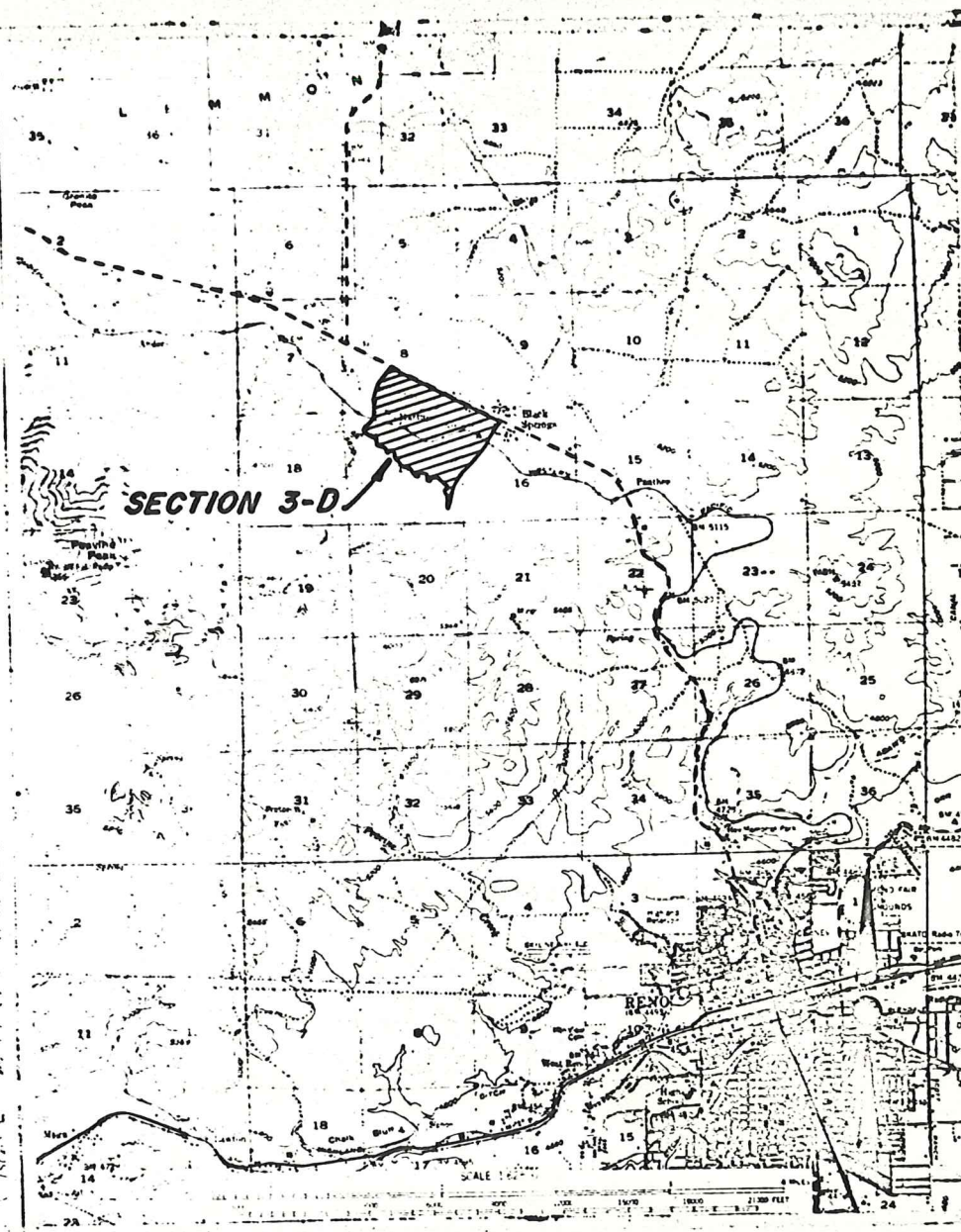

MAP TO ACCOMPANY ORDINANCE 136

Sheet 3 of 3

(71-633) 71-662

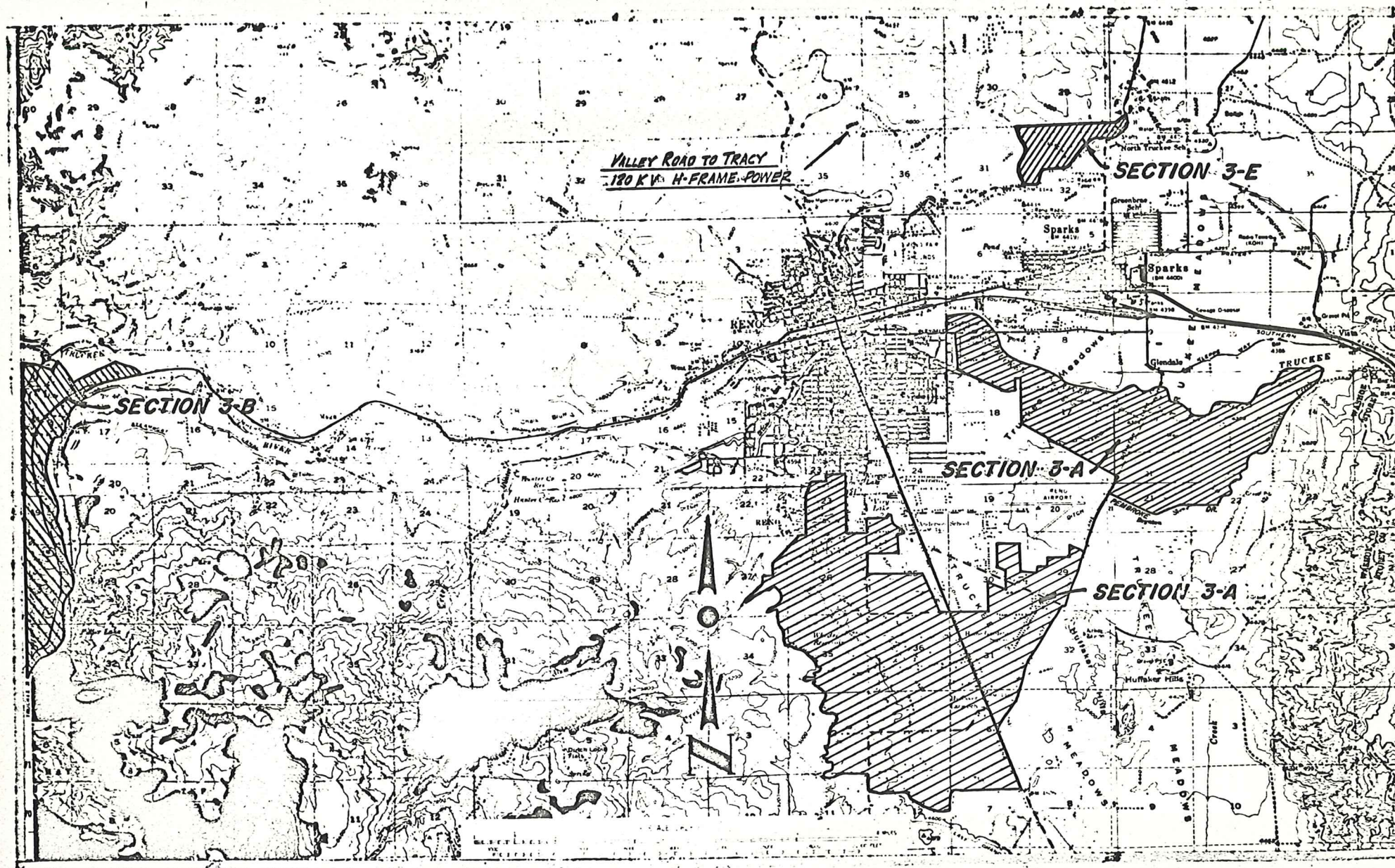

MAP TO ACCOMPANY ORDINANCE 136

Sheet 1 of 3